



Endure #400 Direct Attach Installation Guide

Rulon Endure #400 Direct Attach Installation Guide

Receipt and Storage:

- a. All material shall be delivered to the project site in the original, labeled, unopened packages.
- b. Material shall be stored flat and level in a secured space, preferably in the room or area in which they are to be installed.
- c. Care in handling must be exercised to avoid damage.

Before You Begin Installation:

- a. Ensure that all necessary tools are available (see below)
- b. Check Endure components to ensure all items required are on hand
- c. Review this guide in its entirety.
- d. Review shop drawings if they are required for the installation.

If You Need Further Assistance:

- If you have any questions, or if you encounter a situation not covered by this installation guide, contact the Rulon Engineering Department.
Phone: (904-584-1400)

Tools and Equipment:

- Standard leveling devices
- Hacksaw/Tin Snips
- Power miter saw w/ reversed fine tooth blade
- Loctite PL® S40TM Polyurethane or equal
- (NOTE: Take care not to get Adhesive on Woodgrain)
- Standard Contractor's tools including staple gun/screw gun

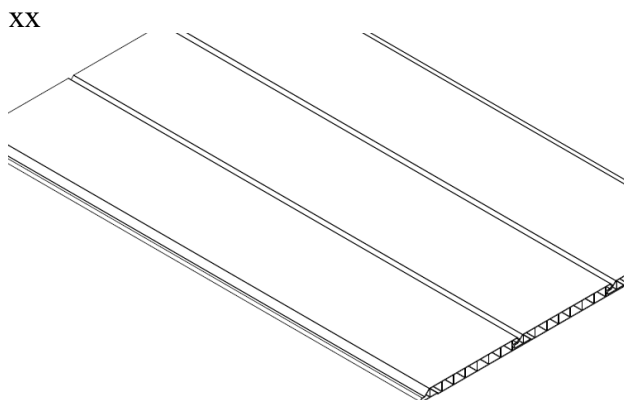

Endure #400 Strips Shown

Ceiling Components:

Supplied by Rulon:

- #400 Direct Attach
- #470 Perimeter Trim

Supplied by others:

- Fasteners, as needed
- Sealant/Adhesive
- Furring or Sheathing
- T-Grid for ceilings

Rulon Endure #400 Direct Attach Installation Guide

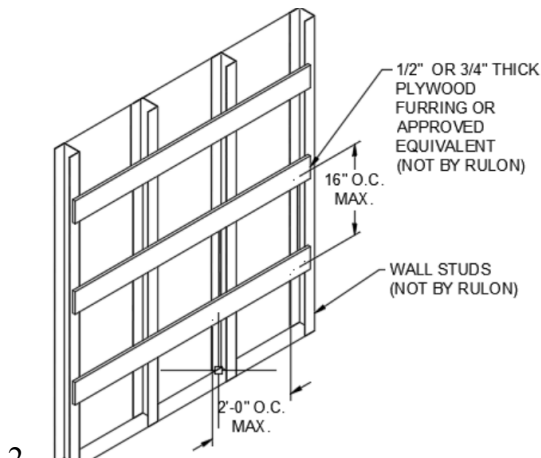

Step 1: Wall Preparation (Ceilings Similar)

Option 1: Vertical Strip Installation – Install furring with weatherproofing as specified. For ceilings, run furring perpendicular to strip direction and direct mount the furring or suspend with t-grid (by others)

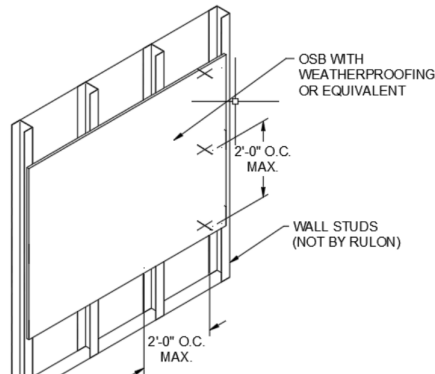

Option 2: (For horizontal or vertical installation) Install OSB or equal as specified. This method and spacing applies to ceilings as well.

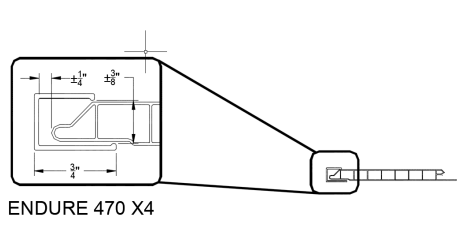

Step 2: Installing 470 Perimeter trim

Use 1/4" Crown Staples 18 Gage 5/8" Long 8 inches to 10 inches o.c to fasten perimeter trim to wall.

Rulon Endure #400 Direct Attach Installation Guide

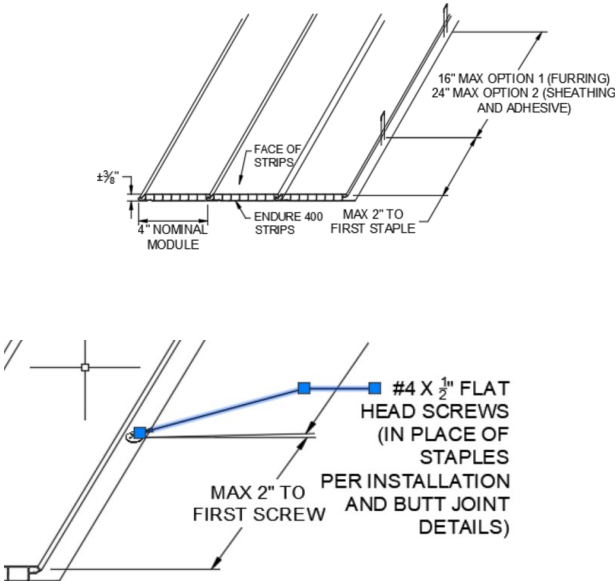

Step 3: Installing #400 Strips

Option 1 (Furring) Use 1/4" Crown Staples 18 Gage 5/8" long to furring on max 16" centers

Option 2 (OSB) Apply Loctite PL® S40TM Polyurethane or equal when installing strips to weatherproofed sheathing (Max 24" on center staples).

Both options: Leave 1/4 Inch of play within perimeter trim to allow for expansion or contraction, and both options are applicable to walls as well as ceilings.

Step 3D: Installing #400 Strips (Optional)

For Seismic or similar considerations, direct screw with fasteners described in lower detail to left

Last Step: Cleaning and Maintenance

Upon completions of the ceiling/wall installation, the contractor shall clean all Endure strips and borders of dirt, dust, grease, oils, fingerprints, etc. using warm, soapy water – followed by a rinse.