



Wood Flat Veneer Tegular Installation Guide

Rulon Wood Flat Veneer Tegular Ceiling Installation Guide

Receipt and Storage:

- a. All material shall be delivered to the project site in the original, labeled, unopened packages. Keep packages of components unopened until it is time to acclimate to the building conditions.
- b. Material shall be stored flat and level in a fully enclosed space. **DO NOT Store Rulon products in direct sunlight.** Seventy-two hours before beginning ceiling installation, wood strips must be moved into the room where the HVAC system is operating, and the packaging shall be opened. This is to allow the boards to adjust to the room environment. Wood panels are to be stored off the floor.
- c. Care in handling must be exercised to avoid damage.

Before You Begin Installation:

- a. Ensure that all necessary tools are available (see below)
- b. Check Wall components to ensure all items required are at hand (see Page 2)
- c. Review this guide in its entirety. If you have any questions, call Rulon Company before you start the installation.
- d. Installation shall be done only when the temperature and humidity closely approximate the interior conditions that will exist when the building is occupied. The heating and cooling systems shall be operating before, during, and after installation, with the humidity of the interior spaces maintained between 25% and 55%, temperature between 60 to 90 degrees F.
- e. It is important that area has proper ventilation, especially in high moisture areas. There shall be no excessive buildup of heat in the space.
- f. Prior to the start of installation, all exterior windows and doors are to be in place, glazed, and weather-stripped. The roof is to be watertight, and all wet trades' work is to be completed, and thoroughly dry.
- g. Mechanical, electrical, and other utility service installations above the ceiling plane shall have been completed. No materials should rest or wrap around the ceiling suspension components or connecting hangers.

If You Need Further Assistance:

- If you have any questions, or if you encounter a situation not covered by this installation guide, contact the Rulon Technical Department.
Phone: 1-800-22RULON (1-800-227-8566), 904-584-1400
Fax: 1-904-584-1499

Tools and Equipment:

- Standard leveling devices
- Saber saw
- Miter saw
- Table Saw
- Painters tape

Rulon Wood Flat Veneer Tegular Ceiling Installation Guide

References:

- ASTM C-635 – Standard Specification for the Manufacture, Performance, and Testing of Metal Suspension Systems for Acoustical Tile and Lay-In Ceilings
- ASTM C-636 – Standard Practice for the Installation of Metal Ceiling Suspension Systems for Acoustical Tile and Lay-In Ceilings
- Optional: ASTM E-1264 – Standard Classification of Acoustical Ceiling Products
- Optional: Seismic Considerations – Refer to Local Code

Rulon Wood Flat Veneer Tegular Ceiling Installation Guide

Ceiling Components:

Supplied by Rulon:

- Wood Flat Veneer Tegular Panels
- Perimeter and border trim (when specified)
- Touch-up finish

Supplied by Others:

- 9/16" [14 mm] Heavy-Duty T-Rail Grid System
- Acoustical Blanket (when specified)
- Perimeter angle or hardware for trim installation

Rulon Wood Flat Veneer Tegular Ceiling Installation Guide

Profiles:

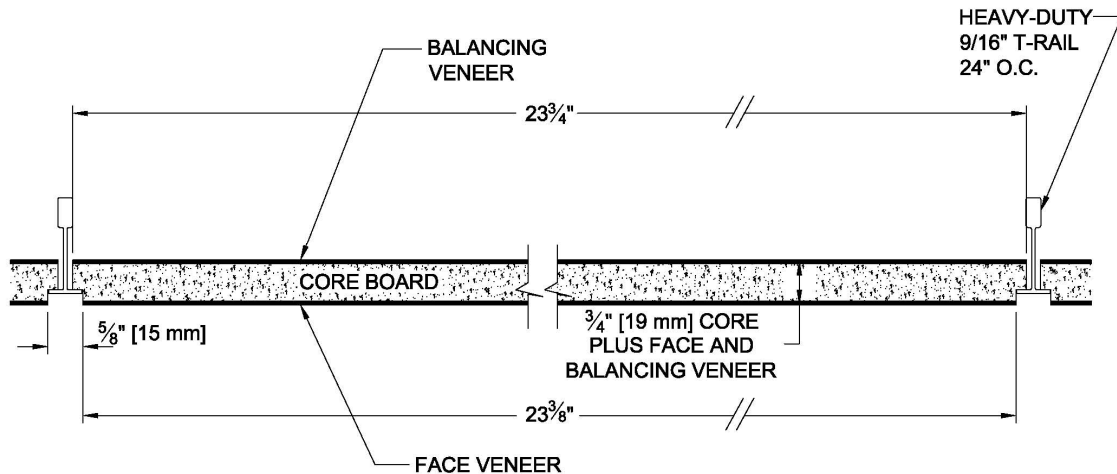

Standard Tegular Profile for 9/16" Grid

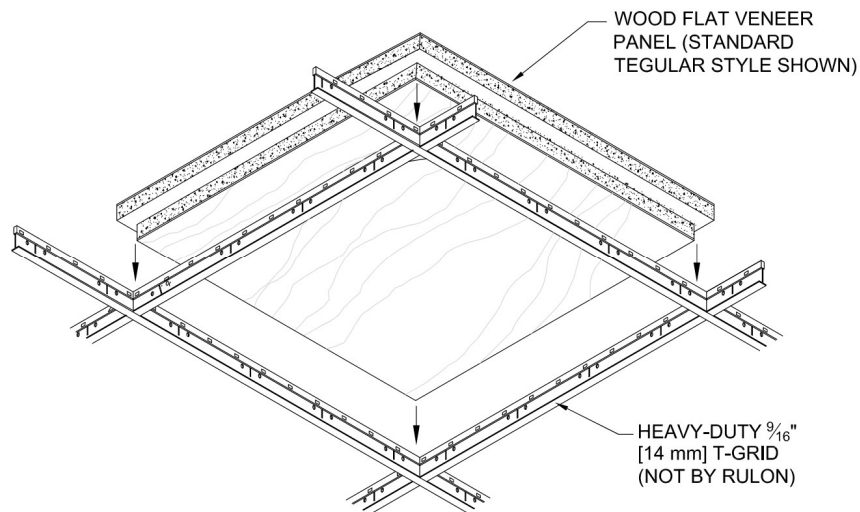

Step 1: Ceiling Grid Preparation

Level and install heavy duty grid throughout the installation area. Heavy duty grid mains shall be supported a maximum of 4' [1219 mm] On Center with #12 Gauge Hanger wire. Hanger wire shall be hung directly from building structure, unless otherwise covered in the Rulon Shop drawings or reviewed and approved by the Rulon Engineering department. If acoustical insulation is required, install prior to laying in panels.

Rulon Wood Flat Veneer Tegular Ceiling Installation Guide

Step 2: Seismic Considerations (Refer to local code)

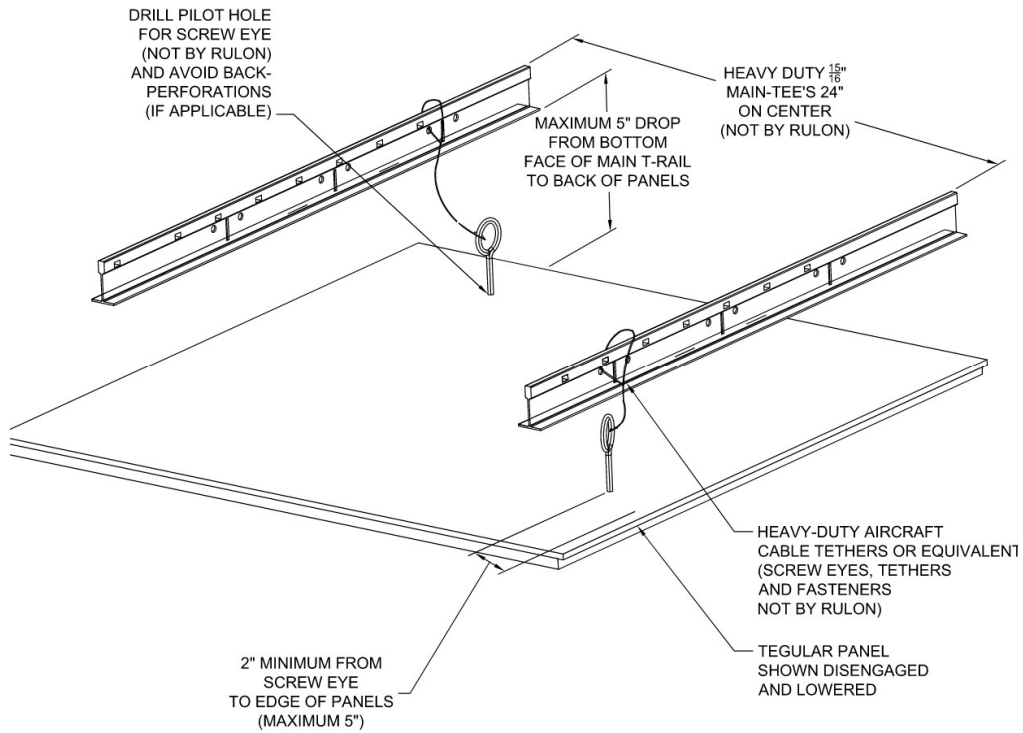

Rulon Wood Flat Veneer Tegular Ceiling Installation Guide

Step 3: Perimeters and penetrations

Panels are to be field trimmed to fit site conditions. Trimming should be done with the appropriate saw, with painters' tape on the veneer side to prevent splintering. Penetration cuts require a saber/jig saw, and perimeter cuts require a miter saw. Cut panels should be touched up with Rulon-supplied finish. **All perimeter panels are to be direct-attached and non-accessible.** For the field-cut panels, Rulon will supply an adequate amount of touch up that should be field applied with a foam brush.

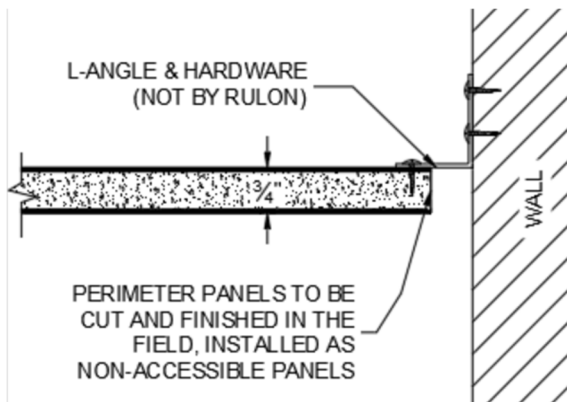

Step 4: Cleanup

1. Clean all wood panels and borders free of dirt, dust, grease, oils, and fingerprints. Routine cleaning is best accomplished with a soft, lint-free cloth lightly dampened with water or an inert household dust attractant. Allowing airborne dust, which is somewhat abrasive, to build up will tend to dull a finish over time. Refer to the Rulon Care and Maintenance document for further instructions.
2. Remove and replace all work that cannot be successfully cleaned or repaired.